

Oct. 5th 1898 P.M.

Preliminary Survey for Sewer Extension to reach city Hospital.

Sewers located 5 ft. South & 5 ft West of St. Ctr.

Set over Mt. 74 - lined with Mt 75 on north and out pt. 5 ft. West - Set over pt 5 ft. West and lined with man hole cover "A" covered and set pt 5' South for cty man hole. Then set stakes every 100 ft. to 27th St. St.

Set over Sta 84+66⁸⁵ and lined to pt. 5' South of Mt 75. Set stakes East every 100 ft. to man hole at Sta 126+81⁵⁶

A. F. Parker C.E.
W. C. Sumner Helper

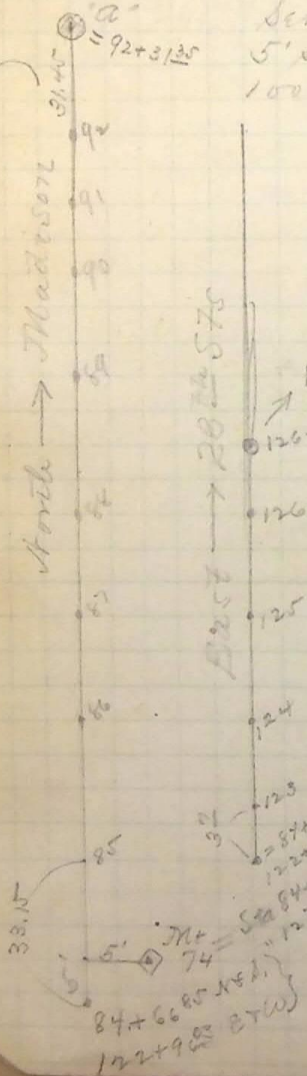

East → 20th 57th

End of Man Hole

126+81⁵⁶

126

125

124

123

122

121

120

119

118

117

33.12
84+66⁸⁵ N 151
122+96⁸³ E 76
84+71⁸⁵ E 21
123+01⁸³ E 84
124+01⁸³ E 84

Next Mon. St. to 52 at 26th & Madison
Next Mon. St. to 51 at 26th & Monroe

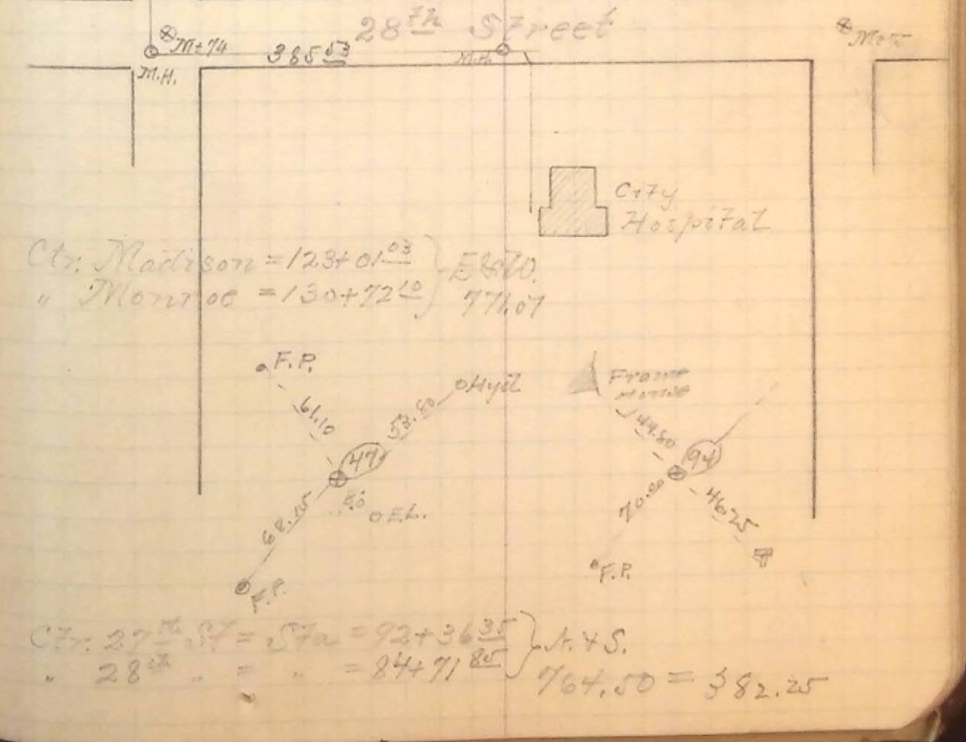
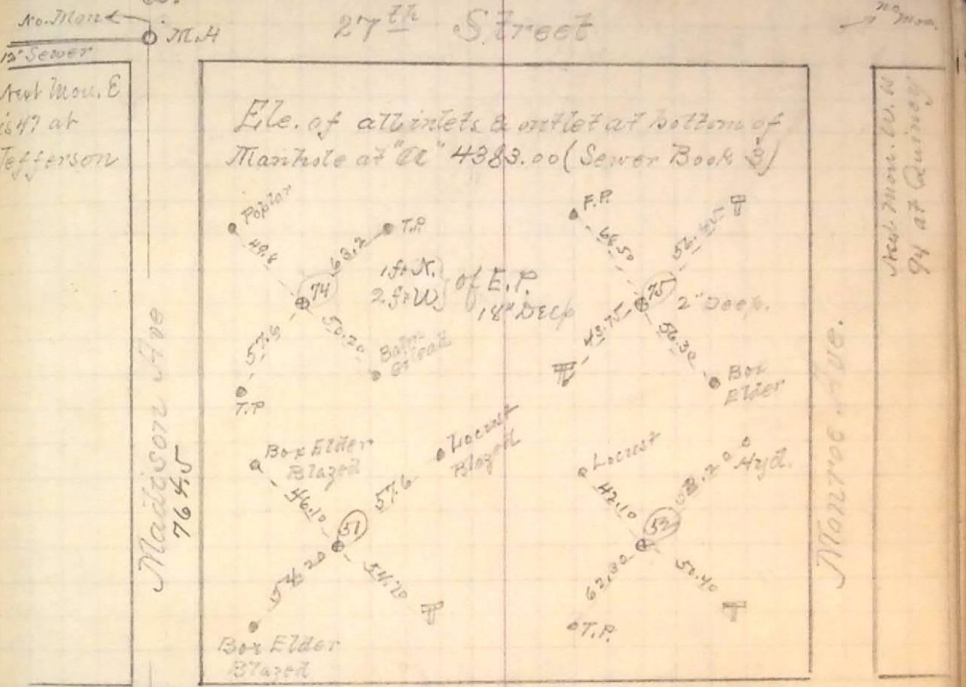

Cty. Madison = 123+01.03 } 5670
" Monroe = 130+92.10 } 7767

Cty. 27th St = Sta = 92+36.35 } 4.45
" 28th = 84+71.85 } 764.50 = 382.25